

Member Info
page 3

Member Recognition
page 3

March Chapter Event
page 4

Calendar
page 5

Programz Corner
the back page



PRESIDENT'S MESSAGE 4TH ANNUAL EDUCATIONAL SYMPOSIUM A SUCCESS

One of our primary reasons for being as a Professional Association is providing educational opportunities to enhance member knowledge in facilities management topics. Our annual Educational Symposium is a successful part of that commitment. This year's topics included Human & Environmental Factors, Communication, Real Estate, Operations & Maintenance, Finance, Quality Assessment and Space Planning.

Our speakers represented companies and organizations from the public sector, private sector and non-profits. Our thanks to the speakers and thanks to **David Allen** and the **McKinstry Company** for sponsoring this year's Symposium. Our thanks also to **Martin Newhard, Linda Flynn, Cynthia Putnam** and **Ray Zimmerman** of the Education Committee for planning and conducting this educational event.

HAVE LUNCH WITH THE CEO: DENNIS LONGWORTH

We're pleased to announce that Dennis Longworth, President and Chief Executive Officer of IFMA, will be joining us for our April Membership meeting. You'll enjoy meeting Dennis and hearing about the State of our Association. Dennis will be available for Q&A and discussion afterward so I encourage you to join us for lunch with the CEO on Wednesday, April 17th.

COUNCILS: YOUR SPECIAL INTEREST GROUP

IFMA Councils are special interest groups sanctioned by our association. They reflect a broad range of specific facilities interests where members can benchmark industry specific best practices and information. Councils have list serves, teleconferences, seminars and annual meetings (usually held in conjunction with the World Workplace). Here's a list of the current IFMA Councils:

Academic Facilities	Health Care
Call Center	Information Technology
Corporate Headquarters	Legal Industry
Environmental, Health & Safety	Museum/Cultural Institutions
FM Consultant's	Public Sector
Financial Services	Research & Development
Utilities	

If one of these councils fits the description of your FM job type, consider joining that council. Membership fees range from free (always a good price) to \$30 per year, depending on the council. Councils are a great source of industry specific information, give one a trial membership. For more council information, go to www.ifma.org and click on "Councils" or email Erica Oliver, Council Resource Manager, at erica.oliver@ifma.org.

officers

president

John Benny, CFM

Facilities West

tel: 425.706.2367
 fax:
 email: j.benny@facilitieswest.com

1st vice president

Ray Zimmerman, CFM

HorizonAir

tel: 206.248.6331
 fax: 206.248.6200
 email: ray.zimmerman@horizonair.com

treasurer

Ann Aumann

University of Washington

tel: 206.598.8476
 fax: 206.598.4036
 email: aaumann@u.washington.edu

secretary

David W. Ling, CFM

Philips Oral Healthcare

tel: 425.396.2506
 fax: 425.396.4851
 email: david.ling@optiva.com

immediate past president

Darren Toshi

Bill & Melinda Gates Foundation

tel: 206.709.3233
 fax: 206.709.3310
 email: darrent@gatesfoundation.org

committee chairs

advertising & promotions

John Balch

Oasis, Inc.

tel: 206.545.7167
 fax: 206.632.7803
 email: johnb@oasisinc.com

associates liaison

Robert Barnes

Herman Miller

tel: 206.442.4353
 fax: 206.386.8968
 email: robert_barnes@hermanmiller.com

education

Martin Newhard, CFM

Heery International, Inc.

tel: 253.752.8235
 fax: 253.752.8237
 email: mnewhard@heery.com

membership

Denyce Cahill

Commercial Office Interiors

tel: 206.577.2782
 fax: 206.448.7338
 email: cahilld@coiseattle.com

newsletter publisher

Mary C. Joyce, CFM

Philips Medical Systems

tel: 206.664.2055
 fax: 206.664.5001
 email: mary_joyce@hsgmed.com

programs (co-chair)

Eric Postle

Puget Sound Properties Comm. Real Estate

tel: 425.586.5646
 fax: 425.455.9138
 email: epostle@pugetsoundproperties.com

public relations & member recognition

Melanie Poteet

Globe Instant Office

tel: 425.656.4194
 fax: 425.251.0759
 email: mpoteet@glbe.com

special events/golf

Dan Maus

Facilities West

tel: 425.337.6637
 fax: 425.316.0609
 email: d.maus@facilitieswest.com

special events

Chris Lewis, CFM

Certified Facility Manager

tel: 206.226.1650
 fax:
 email: chrisandmarcy@earthlink.net

chapter administrator

Shirley Bishop Inc.

tel: 206.367.8704
 fax: 206.367.8777
 email: ifma@shirleybishopinc.com

Seattle News is published monthly by and for the members of the Greater Seattle Chapter of the International Facility Management Association (IFMA). Opinions expressed in Seattle News do not necessarily represent the views of the association, its members, or its Board Members.

IFMA is the premier professional association for facility management. Representing the largest community of FM professionals on the planet, IFMA membership comprises 18,000 facility professionals worldwide.

programs (co-chair)

Rick Knight

DuPont Flooring Systems

tel: 206.241.0229 x864
 fax: 206.241.2699
 email: knightrm@flooring.dupont.com

The Greater Seattle Chapter of IFMA serves to support our members on a local basis. Our Vision is to be an organization that fosters social interaction and opportunities for personal and professional growth within the facility management industry.

For more information or to contact us, please visit our website at www.ifmaseattle.org.

members of mention:
5 years + for March
thank you!

Gregg Baklund
John Balch
Leland Bruch
Ross Buffington, CFM
William Dowing
Lorie Erickson
Tom Hebner
Barry Holldorf, CFM
Jay Johnson
Michael McCadden
Laura Mork
Michael Nolan
Scott Rusch
Jim Sheppard
Simone Steinhaus
Dale Temple
Gary VanDusen
Ray Zimmerman, CFM

Boeing Employees Credit Union
Oasis Inc.
Lee Bruch Facility Focus, LLC
GSA
Dowing Corporation
Harrison Memorial Hospital
Premera Blue Cross
Wizards of the Coast
Multiple Zone International
University of Washington
BF Goodrich Aerospace
City of Renton Facilities Dept.
Fred Hutchinson Cancer Research Ctr.
City of Renton
Starbucks Coffee Co.
Seattle Country Day School
Puget Sound Blood Center & Program
Horizon Air



DEEP THOUGHTS

When cheese gets its picture taken, what does it say?

Ever notice when you blow in a dog's face he gets mad at you, but when you take him in a car he sticks his head out the window?

If a turtle doesn't have a shell, is he homeless or naked?

What was the best thing before sliced bread?

If quitters never win and winners never quit, what fool came up with, "Quit while you're ahead"?!?

Ever notice that anyone driving slower than you is an idiot, but anyone going faster is a maniac?

* Please contact **Kandice Coleman** with any info or interesting tidbits about our members in motion. kandice.e.coleman@flooring.dupont.com

welcome!
new members

Garen L. Martinson
Cindy J. Mitchell
Adelina A. Diaz

Facility Manager
Sales Consultant
Project Manager

The Irving Group
ASI Sign Systems
Mulvanny G2 Arch.

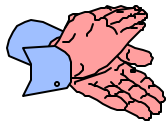

IFMA Membership
Recognition:
Tom Hebner



Tom has been an active IFMA member since March, 1992. Tom began his successful career as the Maintenance/Energy Director for Washington/Alaska Region at Nordstrom. Tom held this position for 10 years, from there he moved to Director of Properties at Pioneer Human Services for two years. The following four years, Tom was the Director of National Service for Starbucks Coffee Company. At that time Tom took his talents to REI, where he worked as the Purchasing & Facilities Director for two years. Now he calls Premera Blue Cross home as their Director of Facility Services.



Tom feels that he has been fortunate to have worked for some of the best companies in the Northwest and that IFMA has played a very strong role in his career development through professional networking, continuing education, qualified vendors and career employment opportunities.

*If you would like to be recognized in an IFMA newsletter, or know a FM who should be, please email **Melanie Poteet** at mpoteet@glbe.com with your profile.*

PRESIDENT'S MESSAGE

continued from front page

BE OUR GUEST

Give yourself a free test drive of one of our meetings. Your first regular chapter meeting registration is on us; come to one of our regular chapter events and your registration is complementary. Check out our award winning web site for our program calendar. www.ifmaseattle.org

LOOKING FORWARD . . .

- To a tour of the new Seattle School Support Center in March
- To Lunch with the CEO at our Annual New Member Event at Getty Images in April
- To a timely educational event on Making Business Proposals in May
- To a tour of the new Seahawk Stadium in June

March Event: Construction Tour of the Support Services Center

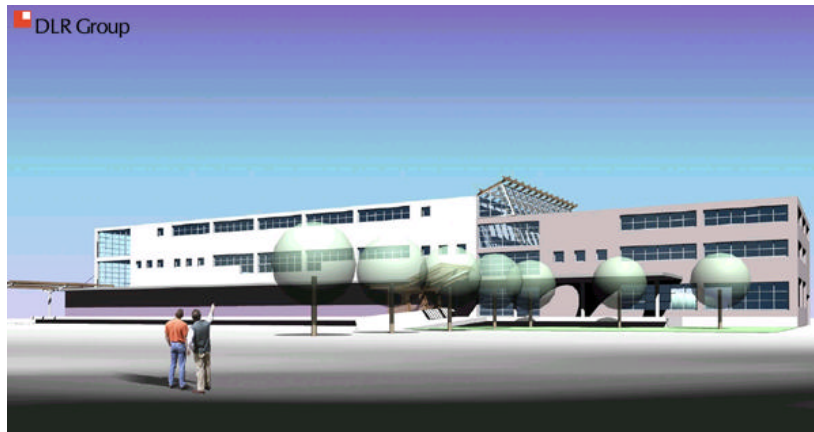

Take a candid look at the former U.S. Postal Service Distribution Center in Seattle's SoDo neighborhood. Currently under construction, this project is an adaptive re-use for the Seattle School District. Upon completion, the facility will serve as the District's Support Services Center, consolidating all administrative functions into one location. Come and learn about how an adaptive re-use can be a creative and cost effective way to approach a building project, and hear first-hand the lessons learned by the team throughout the process.

The Place: 3rd Avenue South & South Lander Street

The Date: Tuesday, March 19, 2002
3:30 – 4:00 registration & networking
4:00 – 5:00 program & Tour
5:00 - refreshments

The Cost: \$10.00 (*IFMA Members*) • \$15.00 (*Non-Members & Walk-Ins*)

Please RSVP No Later Than March 15th!
206-367-8704

***Board Meetings are held on the first Wednesday of the month at 7:30am.*

March 2002

*19th - Building Tour - Afternoon Event!
Adaptive re-use of former US Postal Service
Distribution Ctr for the Seattle Public
School's Support Svcs Ctr*

April 2002

*17th - New Members Luncheon with
Dennis Longworth, IFMA Pres & CEO -
Afternoon Event! @Getty Images*

May 2002

*9th & 10th - IFMA R&D and EHS Spring
Conference - Orlando, FL
21st - How to Develop a Case Study for your
Business Proposal @Getty Images*

June 2002

18th - Tour of Seahawk's Stadium

July 2002

16th - Summer IFMA Picnic

August 2002

20th - Vendor Vignette

September 2002

*11th - Golf Event!
@Washington National*

October 2002

*15th - Starbuck's Earthquake Recovery
Plan*

November 2002

19th - TomorrowSpace

December 2002

2nd - Annual Holiday Event

January 2003

Chapter Event

February 2003

Chapter Event

Programz Corner

Melanie D. Poteet, Programs Committee

After many inquiries and requests for an afternoon event, we have our first in March. So mark your calendars for the afternoon of the 19th. We will take a tour of the former U.S. Postal Service Distribution Center in Seattle's SoDo neighborhood. This facility is currently under construction and will serve as the District's Support Services Center. Please see the flyer enclosed in this newsletter for more details.

In April we will have our Annual New Members Breakfast. This event will take place mid-day on April 17th at Getty Images in Fremont. We will have a special keynote speaker: Dennis Longworth, President and Chief Executive Officer of IFMA.

For May we have planned an informational meeting, "How to Develop a Case Study for your Business Proposal." This information should prove very useful for Facility Managers who are required to produce these studies, or for those who just want to be prepared in case this need arises. Watch the newsletter and website for more information!

IFMA GREATER SEATTLE CHAPTER
2150 North 107th, Suite 205
Seattle, WA 98133-9009

FIRST CLASS
MAIL
US POSTAGE
PAID
SEATTLE, WA
PERMIT #3583